

PŘÍSLUŠENSTVÍ K ČÍSELNÍKOVÝM ÚCHYLKOMĚRŮM

Měřicí doteky k číselníkovým úchylkoměrům

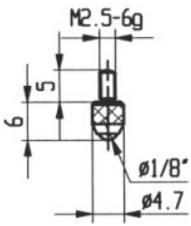

M2/70

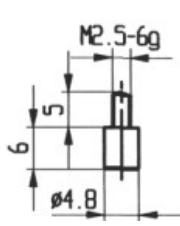

573/10

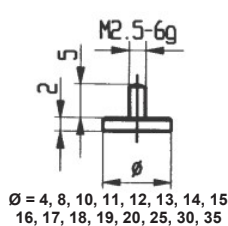

Ø = 4, 8, 10, 11, 12, 13, 14, 15, 16, 17, 18, 19, 20, 25, 30, 35

573/11

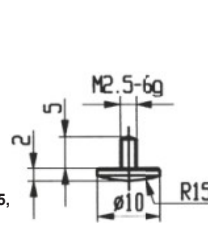

573/12

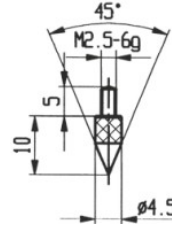

573/13

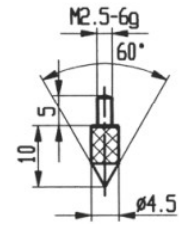

573/13-60

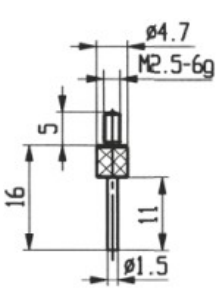

573/14

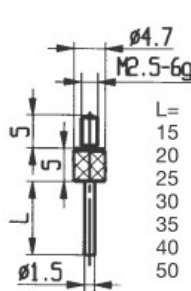

573/14 L

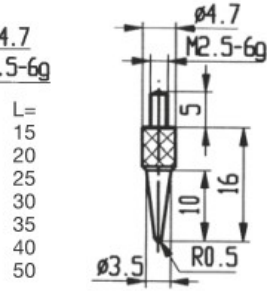

573/15

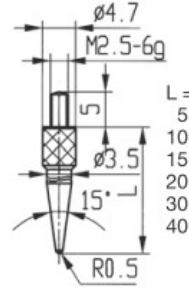

573/15 L

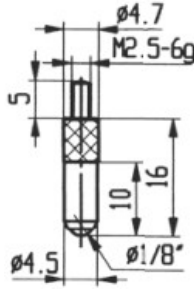

573/16

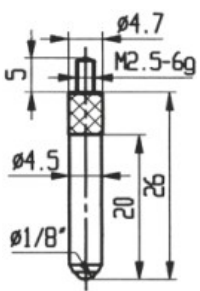

573/17

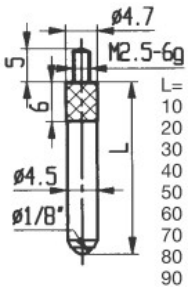

573/17 L

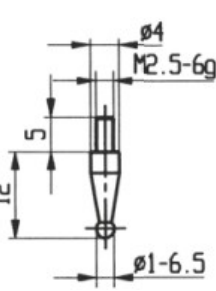

573/18

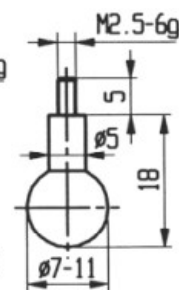

573/19

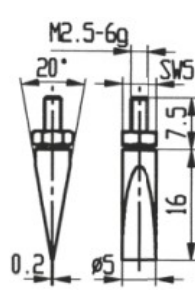

573/20 E

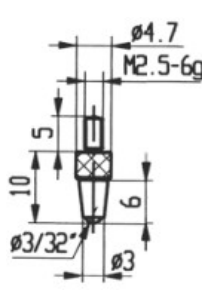

573/21

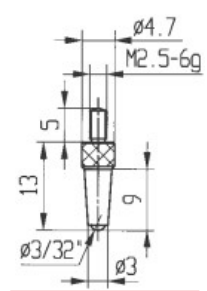

573/21 L-13

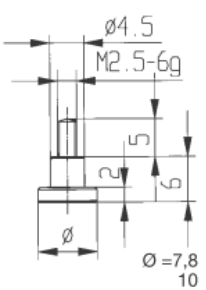

573/22

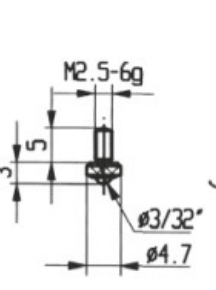

573/23

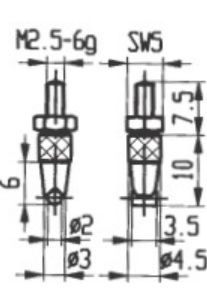

573/24 E

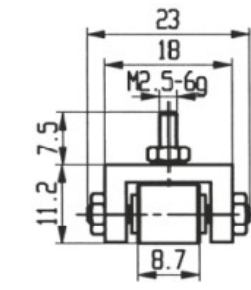

573/25 E

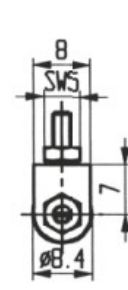

573/27 E

- se závitem M 2.5 pro použití s doteky 573/18 Ø 1-6 mm a
- se závitem M 1.6 pro použití s doteky pro páčkové úchylkoměry

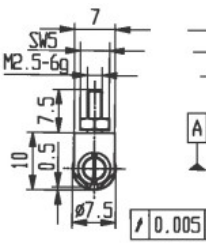

573/28 E

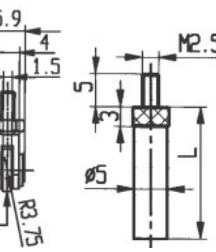

573/29 L

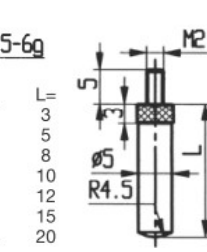

573/30 L

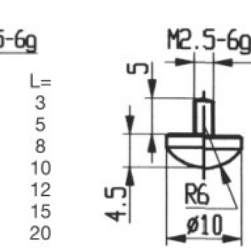

573/32

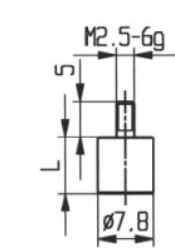

573/35 L

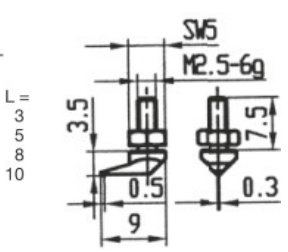

573/39 E

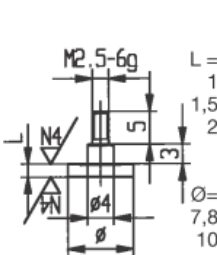

573/40-D-L

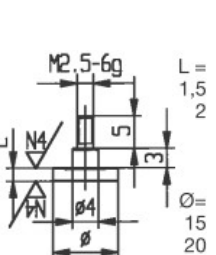

573/41-D-L

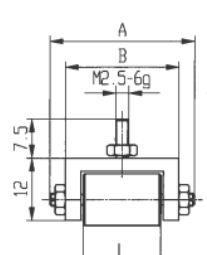

573/50 E

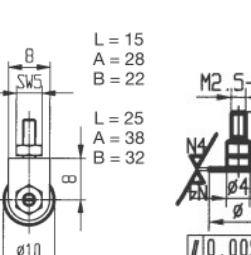

573/51

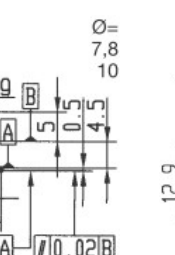

573/52 E

Měřicí doteky k číselníkovým úchylkoměrům - tvrdokov (H), rubín (R), safír (S), keramika (C), plast (KU)

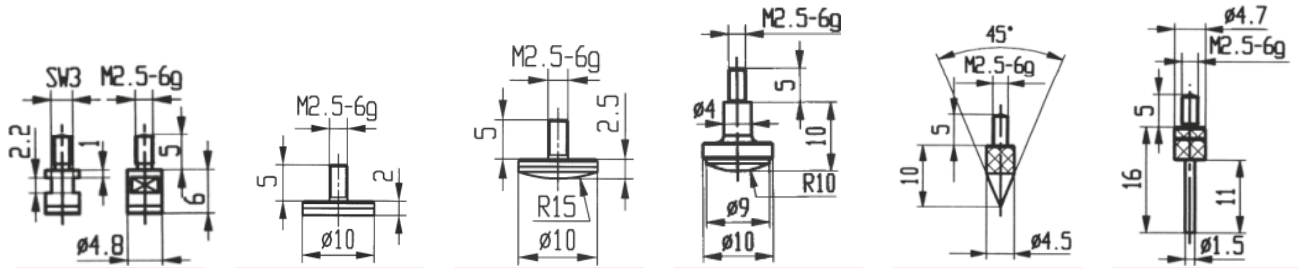

573/10 H

573/11 H/C

573/12 H/C

573/12-10 H

573/13 H

573/14 H

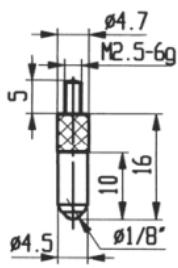

573/16 H/R/S

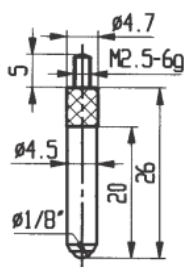

573/17 H/R/S

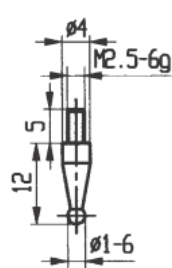

573/18 H

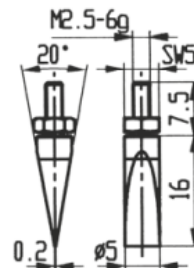

573/20 HE

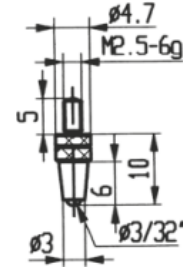

573/21 H

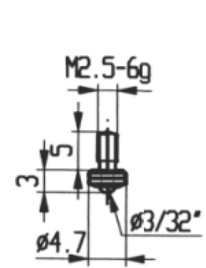

573/23 H

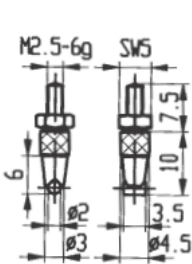

573/24 HE

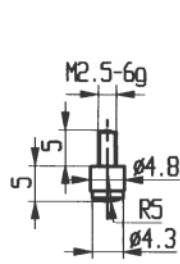

573/31 H

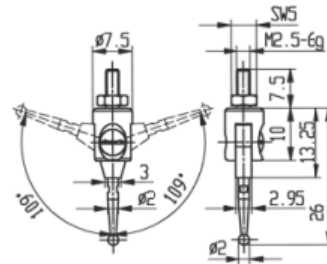

573/33 HE

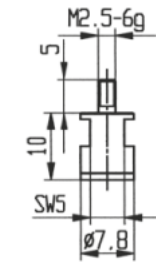

573/35 H

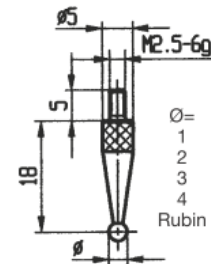

573/42 R

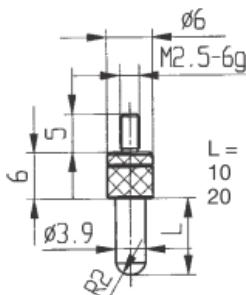

573/43 HL

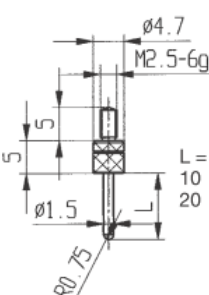

573/44 HL

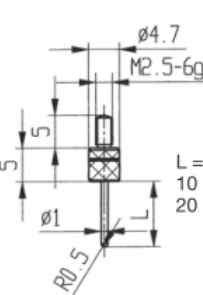

573/45 HL

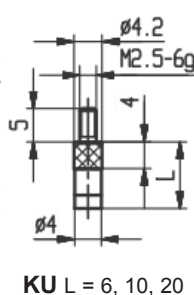
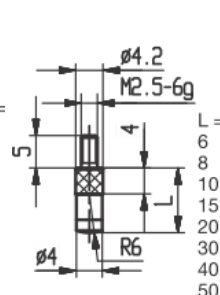
573/47 HL
573/47 KUL

573/48 HL

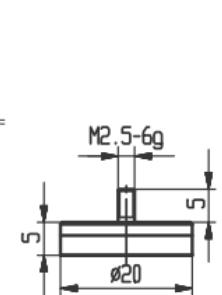

573/49 H

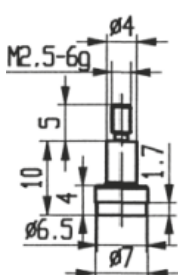

573/102 H

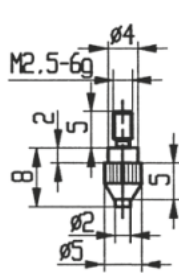

573/105 H

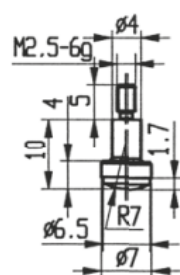

573/108 H

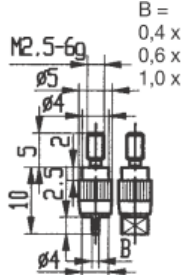

573/110 H

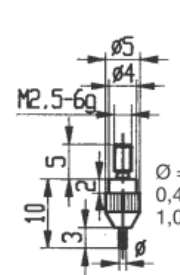

573/112 H

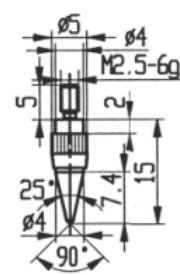

573/114 H

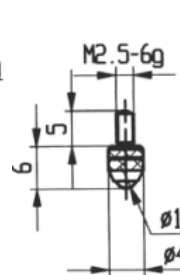

M 2/70 H/R/S/C/KU

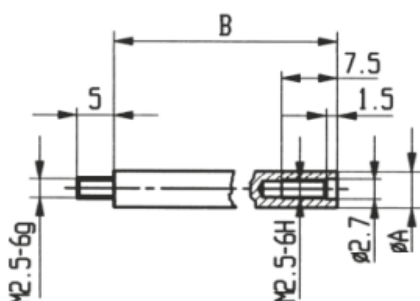

Prodloužení k číselníkovým úchylkoměrům

Rozměr „A“, u číselníkových úchylkoměrů s měřícím dílkem \varnothing 4 mm4 mm

Rozměr „A“, u číselníkových úchylkoměrů s měřícím dílkem \varnothing 5 mm5 mm

Rozměr B - standardní provedení délka:

10, 15, 20, 25, 30, 35, 40, 45, 50, 55, 60, 65, 70, 75, 80, 85, 90, 95 a 100 mm.